

Project		Part Num		Prepared By	
Type		Notes		Date	

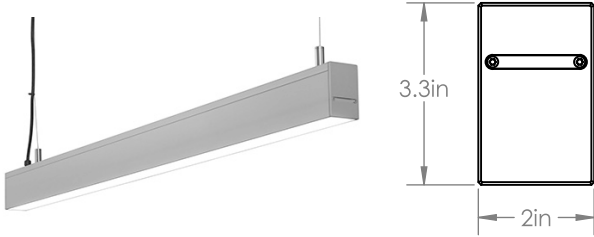

### Product Features

- 2" Linear Suspended Direct LED Luminaire
- PERFEKTLight Technology
- Full spectrum and circadian influential
- Tunable white and multiple color temperature options
- PERFEKDay Control or 0-10V dimming
- Flicker Free



### Ordering Information

Sample Part Number: PB2S-04515W-952760-074D-PDIW-120I-G

Product ID		Length		Output		Finish		CRI / CCT				Angle		
PB2S	PERFEKTBeam2 Suspended Direct LED	04	4ft Nominal	515	515 lm/ft <sup>1</sup>	W	White	952760	95+ CRI, 2700K to 6000K Tunable White				074	74° FWHM <sup>5</sup>
			8ft Nominal	775	775 lm/ft <sup>2</sup>			902760	90+ CRI, 2700K to 6000K Tunable White					
		08		900	900 lm/ft <sup>3</sup>			802760	80+ CRI, 2700K to 6000K Tunable White					
				1000	1000 lm/ft <sup>4</sup>			802060	80+ CRI, 2000K to 6000K Tunable White					
								9027	90+ CRI, 2700K					
								9030	90+ CRI, 3000K					
								9035	90+ CRI, 3500K					
								9040	90+ CRI, 4000K					
								9050	90+ CRI, 5000K					
								8027	80+ CRI, 2700K					
			8030	80+ CRI, 3000K										
			8035	80+ CRI, 3500K										
			8040	80+ CRI, 4000K										
			8050	80+ CRI, 5000K										
		Custom lengths available upon request.		<sup>1</sup> Only for 95+ CRI <sup>2</sup> Only for 90+ CRI 2700K to 6000K <sup>3</sup> For 80+ CRI 2700K to 6000K and 80+ CRI 2000K to 6000K <sup>4</sup> Only for Monochromatic Custom outputs available upon request.		Custom finishes available upon request.		Custom CRI and CCT options available upon request. Tunable White options provide color temperate adjustment between 2700K to 6000K or 2000K to 6000K. Can be used with the PERFEKDay Controller or two 0-10V controls, one for color temperature, one for brightness.				5 Additional viewing angles available upon request.		

Lens		Control		PDC Position		PDC Interface		Voltage		Power Supply		Mounting		Accessory	
D	Diffused	PD	PERFEKDay Controller	I	Internal	W	Wired	120	120V	I	Internal	G	Grid	Blank	None
		2V	0-10V x two channels	E	External	B	Bluetooth <sup>7</sup>	277	277V	E	External	C	Cable	DD	Dual Dimmer
		1V	0-10V x one channel <sup>6</sup>									N	None	OS	Occupancy Sensor
		6 Monochromatic only				7 Only available with PERFEKDay Controller		Other voltages available upon request						Separate accessory options with a (-)	

## Product Specifications

### Construction

Housing extruded from 6063 aluminum  
Powder coated in a brilliant white finish  
additional finishes available, contact  
factory

Endcaps machined from aluminum  
Lenses precision cut from Acrylic QMFZ2

### Light Engines

Choice of monochromatic 2700K,  
3000K, 3500K, 4000K, and 5000K  
Choice of tunable white 2700K to  
6000K or 2000K to 6000K

CRI options for tunable white and  
monochromatic in 80+, 90+ and 95+

Fidelity, Rf, and Gamut, Rg, ratings of:  
Full Spectrum Rf and Rg 95 to 105 typ  
High Efficiency Rf  $\geq 75$  Rg  $\geq 90$   
Wide Range Rf  $\geq 70$  Rg  $\geq 90$   
Monochromatic Rf  $\geq 70$  Rg  $\geq 90$

Input Voltage 24VDC

### Power Supply

Input Voltage 120 or 277VAC  
additional input voltage ranges available,  
contact factory

### Controls and Sensors

Monochromatic single 0-10V input for  
dimming from 100% down to 1%

Tunable White dual 0-10V inputs, one for  
brightness 100% down to 1% and one for  
color min to max cct

PERFKTDay Controller

DualDimmer wall mount dual sliders

Occ, Day, and Day/Occ Sensors

### Mounting

Suspended via aircraft cable

### Lengths

Available in 4ft and 8ft lengths. Custom  
lengths available, contact factory for  
additional details.

### Lumen Output

Custom lengths outputs available, contact  
your factory for additional details.

### Weight

1.2 lbs (0.54 kg) per foot

### Certifications

UL listed for dry locations

### Warranty

Five year limited warranty

## Performance Data

	CCT Range	Nominal Output	Color Deviation	Fidelity	Gamut	CRI	Power
Full Spectrum	2700K to 6000K	467 to 515 lm/ft	0.001 Du'v' Typ. ( $<1$ MacAdam's Ellipse)	95 to 105	95 to 105	95 to 99	7 to 7.5 W/ft
High Efficiency	2700K to 6000K	700 to 900 lm/ft		75 to 90	90 to 110	80 to 90	7 to 7.5 W/ft
High Efficiency	2700K to 6000K	575 to 775 lm/ft		85 to 100	90 to 105	90 to 98	7 to 7.5 W/ft
Wide Range	2000K to 6000K	550 to 900 lm/ft		70 to 85	90 to 110	80 to 95	7 to 8 W/ft
Monochromatic	2700K	1000 lm/ft	3 Step	$\geq 70$	$\geq 89$	80+	8.8 W/ft
	3000K	1000 lm/ft	3 Step	$\geq 70$	$\geq 89$	80+	8.8 W/ft
	3500K	1000 lm/ft	3 Step	$\geq 70$	$\geq 89$	80+	8.8 W/ft
	4000K	1000 lm/ft	3 Step	$\geq 70$	$\geq 89$	80+	8.8 W/ft
	5000K	1000 lm/ft	3 Step	$\geq 70$	$\geq 89$	80+	8.8 W/ft
	2700K	1000 lm/ft	3 Step	$\geq 70$	$\geq 89$	90+	9.8 W/ft
	3000K	1000 lm/ft	3 Step	$\geq 70$	$\geq 89$	90+	9.8 W/ft
	3500K	1000 lm/ft	3 Step	$\geq 70$	$\geq 89$	90+	9.8 W/ft
	4000K	1000 lm/ft	3 Step	$\geq 70$	$\geq 89$	90+	9.8 W/ft
5000K	1000 lm/ft	3 Step	$\geq 70$	$\geq 89$	90+	9.8 W/ft	

\* All performance data subject to change without prior notification.

## Photometric Data

### Polar Curves

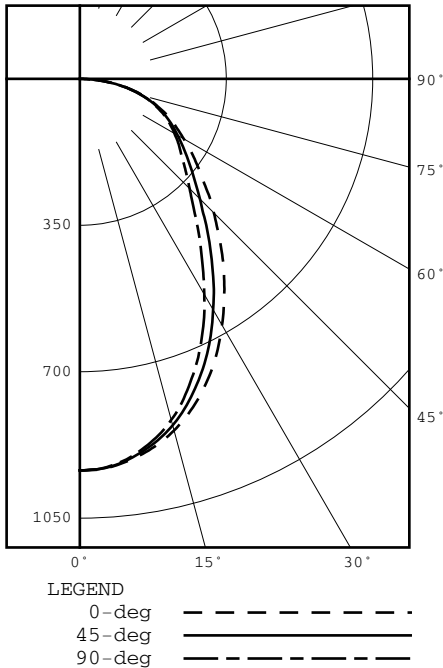

### Candela Distribution

Vertical Angles	Horizontal Angles				
	0	22.5	45	67.5	90
0	936	936	936	936	936
5	929	928	928	926	926
15	870	860	857	848	844
25	755	736	721	699	688
35	602	580	553	519	506
45	453	434	406	379	371
55	335	322	308	295	292
65	245	240	235	231	231
75	158	157	156	153	154
85	52	52	50	49	50
90	0	0	0	0	0

### Zonal Lumens

Zone	Lumens
0	0
0-10	88
10-20	240
20-30	330
30-40	346
40-50	317
50-60	278
60-70	234
70-80	163
80-90	55
90	0

Part Num: PB2S-04515W-952760-074D-PDIW-120I-G  
 LUMENS: 2050lm  
 LPW: 73.7 LPW  
 CCT: 4000K  
 WATTS: 27.8W  
 TESTED ACCORDING TO IESNA LM-79-2019

### Polar Curves

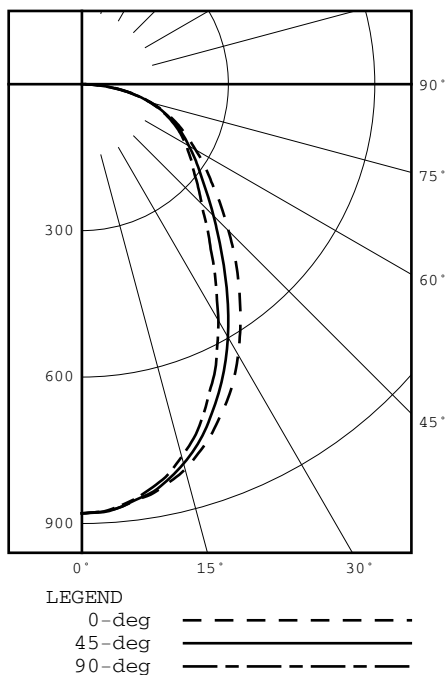

### Candela Distribution

Vertical Angles	Horizontal Angles				
	0	22.5	45	67.5	90
0	879	879	879	879	879
5	871	872	871	871	868
15	817	807	805	795	790
25	709	692	675	655	646
35	566	545	518	489	475
45	425	405	381	356	347
55	314	302	289	277	274
65	230	225	221	216	216
75	148	146	146	143	144
85	49	47	47	45	45
90	0	0	0	0	0

### Zonal Lumens

Zone	Lumens
0	0
0-10	82
10-20	226
20-30	310
30-40	324
40-50	297
50-60	261
60-70	219
70-80	153
80-90	51
90	0

Part Num: PB2S-04515W-952760-074D-PDIW-120I-G  
 LUMENS: 1922lm  
 LPW: 72.5 LPW  
 CCT: 3000K  
 WATTS: 26.5W  
 TESTED ACCORDING TO IESNA LM-79-2019

# PERFEKTLIGHT

To meet the ever-changing demands of healthcare, retail, education, hospitality, commercial office, and high-end residential applications, **PERFEKTLight** is a breakthrough tunable white lighting technology that imitates sunlight to synchronize your circadian clock promoting health and wellness. This patent pending core technology utilizes a combination of cutting-edge cool white, warm white, and green LEDs correcting hue errors inherent with other tunable white technologies. Maintaining a position on the black body curve across the full color spectrum within 0.001Du'v, **PERFEKTLight** provides an exceptional CRI (95 to 98), while automatically adjusting the color temperature between 2700K and 6000K over the course of the day.

Further defining features of PERFEKTLight are the comprehensive color content along with Set & Forget Control. Mimicking the spectral power density of the sun, it comes factory set based on geographic location and automatically adjusts the color temperature throughout the day, perfectly delivering 12 hours of blue/cyan-enriched light during the day and red/orange-weighted light at night. Additional controls are available including an intuitive Bluetooth app, available for Android and iOS.

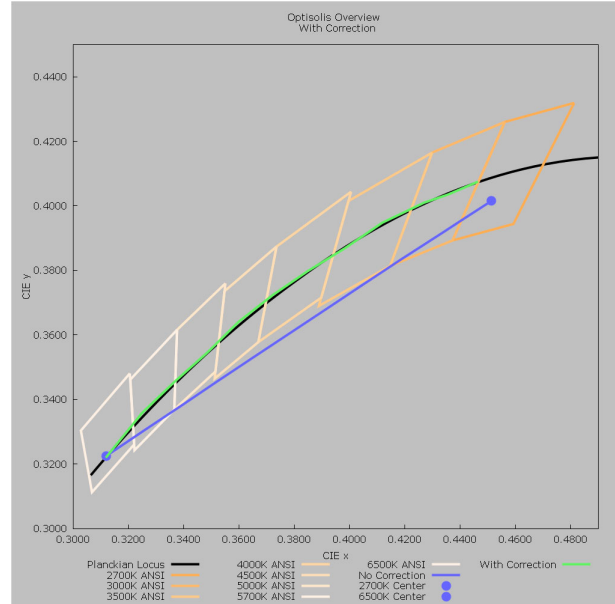

Without Correction ——— With Correction ———

## 2700K

CRI = 96 | Rf = 95 | Rg = 102 | CQS = 96 | M/P = 0.49\*

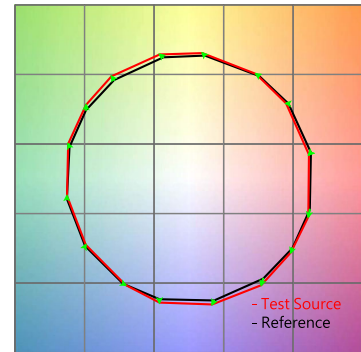
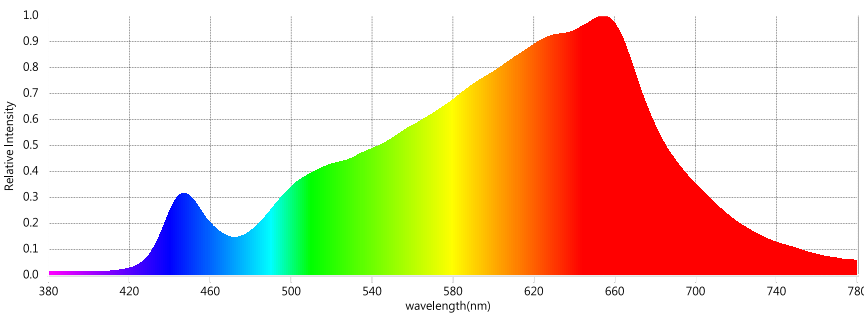

## 6000K

CRI = 99 | Rf = 99 | Rg = 100 | CQS = 99 | M/P = 1.1\*

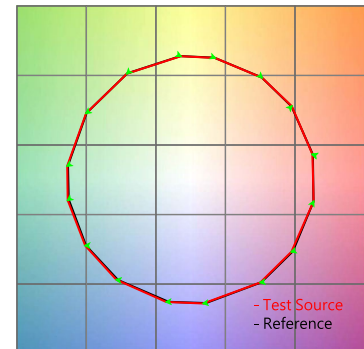
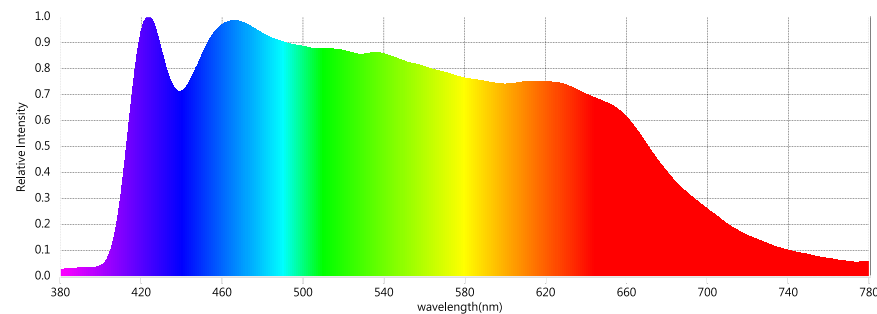

\*Calculated using the WELL Building standard and ITL spectral data.

## Mechanical Drawings

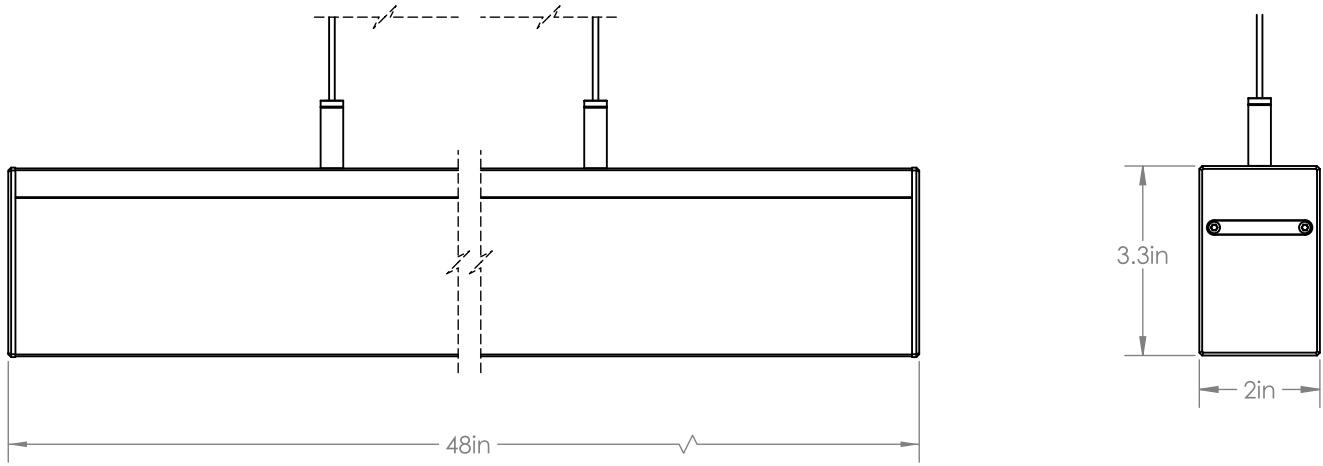

## Mounting Options

