

# LO

LUMA SERIES

A staple for many lighting specifiers, the LO delivers a light distribution that is ideal for general lighting when significant illumination is required.

Manufactured in America and constructed with a sturdy extruded aluminum housing, the **LO** delivers superior lumen output from a very low-profile package. Produced in both standard output and high output, the **LO** includes onboard 0 – 10 V<sub>DC</sub> dimming and both fixed and articulating mounting options to deliver the maximum versatility for nearly any linear application.

Offered with either a clear or frosted lens option and able to serve dry environments, with a damp option available, the **LO** satisfies many needs for specifiers around the globe. Touting all these features, it is easy to understand why **LO** has been specified as the ideal solution for demanding applications that include cove, accent and task lighting.

## Features

- Made in America quality and craftsmanship
- Five CCTs and four colored LED standard options
- Customizable fixture lengths, CCT and CRI available
- Powder coated, low profile aluminum extrusion for seamless integration
- Fixed and articulating mounting options
- Fixtures can be daisy chained to form a longer run and energized from a single driver
- Multiple lens options
- Onboard 0 - 10V<sub>DC</sub> dimming circuitry

## Mechanical Profile & Compliance



- All dimensions in INCHES



# Low Voltage Linear Luminaire

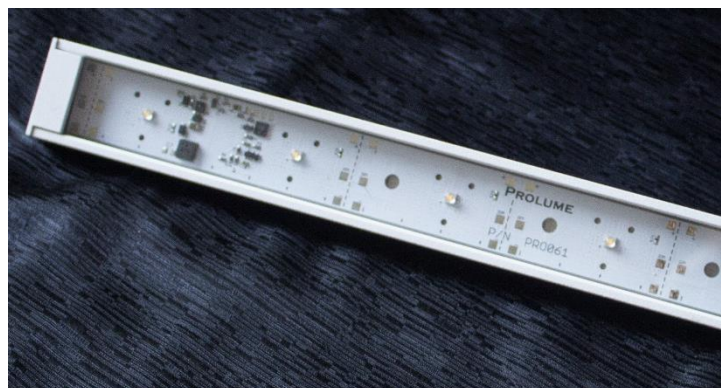

Specifications					
CCT	2700K	3000K	3500K	4000K	5000K
LED Pitch	2"				
Lumen Output					
Clear & SO	485	485	487	561	650
Clear & HO	618	618	621	717	844
Frosted & SO	423	423	424	449	520
Frosted & HO	538	538	541	574	676
CRI	80+ & 90+				
Beam Angle	115°				
Lens	Clear & Frosted				
Dimmable	Yes				
On Board Dimming	Yes				
Construction	Aluminum & Plastic				
Housing	White Powder Coated Aluminum				
Fixture Length <sub>Min</sub>	SO 5"   HO 5"				
Fixture Length <sub>Max</sub>	SO 102"   HO 96"				
Ordering Increments	1"				
Daisy-Chain Capable	Yes				
Power Consumption <sub>W/Ft</sub>	SO 7W   HO 10W				
Efficacy <sub>LM/W</sub>					
Clear & SO	69	69	70	80	93
Clear & HO	62	62	62	72	84
Frosted & SO	60	60	61	64	74
Frosted & HO	54	54	54	57	68
Power Supply	Class II				
Operating Voltage <sub>DC</sub>	24V				
Fixture Connectors	Indoor PlugnGo, Outdoor PlugnGo, Flying Leads				
Fixture Mounting	Fixed Mounting Clip, Articulating Mounting Clip				
Environmental Rating	Dry				
Certifications	UL				
Warranty <sub>Limited</sub>	5 years				
Product Dimensions <sub>WxH</sub>	1.25 x 0.50 in				
Operating Temp Range	-40 to 140 °F				
Storage Temp Range	-40 to 180 °F				
Weight	0.60 lb / ft				

Specifications subject to change without prior notification

## Ordering Information

Example: LO-23H-827-115C-LE-IRB-FM

Product	Length <sup>1</sup>	Output	CRI <sup>2</sup>	Color	Beam Angle	Lens	Ingress Cable Orientation	iPosition	Termination <sup>3</sup>	Ingress Opposite Orientation <sup>4</sup>	Egress Cable Position	Mount
LO	##	<u>SO</u>	<u>80+</u>	27	115	<u>C</u> lear	<u>L</u> eft	<u>E</u> nd	<u>I</u> PG	<u>R</u> ight	<u>X</u> - None	FM - Fixed Mount
		<u>HO</u>	<u>90+</u>	30		<u>F</u> rosted	<u>R</u> ight	<u>B</u> ack	<u>O</u> PG	<u>L</u> eft	<u>E</u> nd	AM - Articulating Mount
				35				<u>N</u> earside	<u>F</u> ly		<u>B</u> ack	
				40				<u>F</u> arside			<u>N</u> earside	
				50							<u>F</u> arside	
				RED								
				GRN								
				BLU								
				YLW								

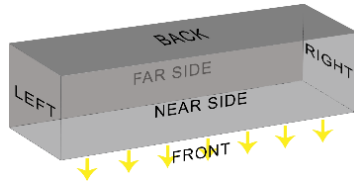

<sup>1</sup> Fixture length in inches, <sup>2</sup> CRI does not apply to Colors; leave blank <sup>3</sup> Indoor PlugGo, Outdoor PlugGo or Flying leads <sup>4</sup> Will always be the opposite letter of the Ingress Cable Orientation (R or L)

## Mounting Clips

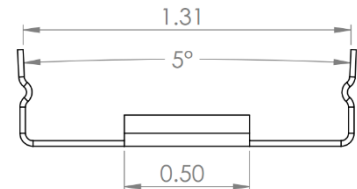
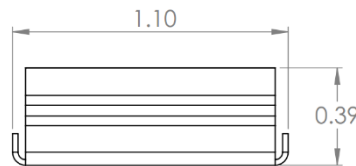
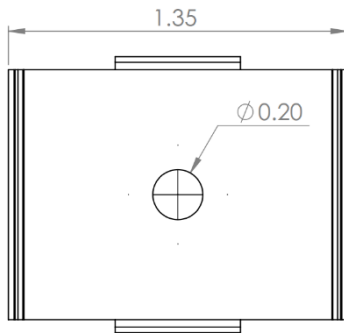

Fixed Mounting Clip

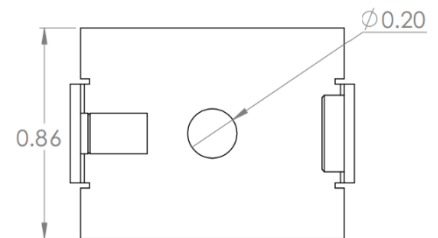
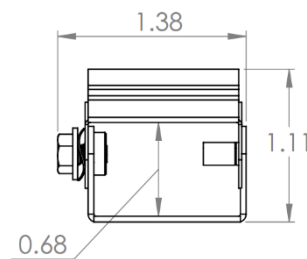
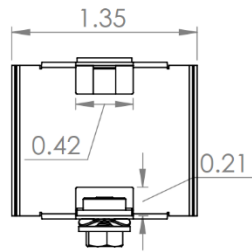
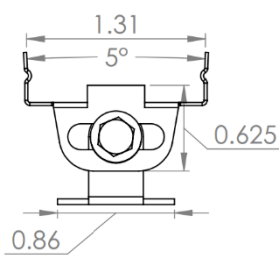

Articulating Mounting Clip

- All dimensions in INCHES

## Dimming

The **Luma Series** of products are designed with a built-in dimming circuit that requires a 0 - 10 V<sub>DC</sub> sinking dimming controller to properly function. Either a third party sinking dimmer controller can be used or one of two available options in the LEDynamics LVD Series of products.

