

LOW VOLTAGE LINEAR LUMINAIRE

A staple for many lighting specifiers, the LO delivers a light distribution that is ideal for general lighting when significant illumination is required.

Manufactured in America and constructed with a sturdy extruded aluminum housing, the LO delivers superior lumen output from a very low-profile package. Produced in both standard output and high output, the LO includes onboard 0 – 10 V_{DC} dimming and both fixed and articulating mounting options to deliver the maximum versatility for nearly any linear application.

Offered with either a clear or frosted lens option and able to serve dry environments, with a damp option available, the LO satisfies many needs for specifiers around the globe. Touting all these features, it is easy to understand why LO has been specified as the ideal solution for demanding applications that include cove, accent and task lighting.

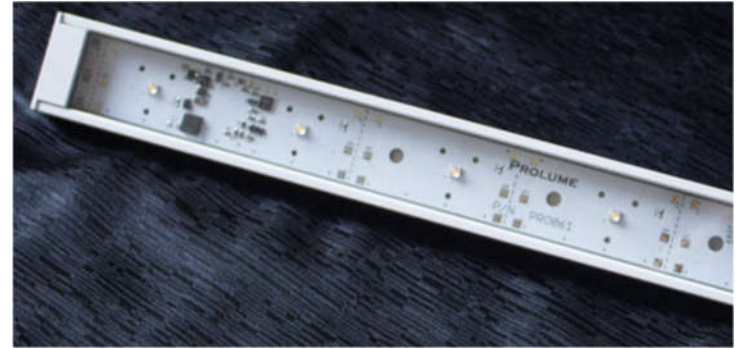

Features

- Made in America quality and craftsmanship
- Five CCTs and four colored LED standard options
- Customizable fixture lengths, CCT and CRI available
- Powder coated, low profile aluminum extrusion for seamless integration
- Fixed and articulating mounting options
- Fixtures can be daisy chained to form a longer run and energized from a single driver
- Onboard 0 - 10V_{DC} dimming circuitry

Mechanical Profile & Compliance

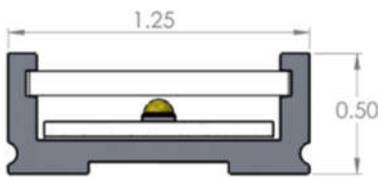

- All dimensions in INCHES

Specifications					
CCT	2700K	3000K	3500K	4000K	5000K
LED Pitch	2"				
Lumen Output					
Clear & SO	485	485	487	561	650
Clear & HO	618	618	621	717	844
Frosted & SO	423	423	424	449	520
Frosted & HO	538	538	541	574	676
CRI	80+ & 90+				
Beam Angle	115°				
Lens	Clear & Frosted				
Dimmable	Yes				
On Board Dimming	Yes				
Construction	Aluminum & Plastic				
Housing	White Powder Coated Aluminum				
Fixture Length _{Min}	SO 5" HO 5"				
Fixture Length _{Max}	SO 102" HO 96"				
Ordering Increments	1"				
Daisy-Chain Capable	Yes				
Power Consumption _w	SO 7W HO 10W				
Efficacy _{LM/w}					
Clear & SO	69	69	70	80	93
Clear & HO	62	62	62	72	84
Frosted & SO	60	60	61	64	74
Frosted & HO	54	54	54	57	68
Power Supply	Class II				
Operating Voltage _{dc}	24V				
Fixture Connectors	Indoor PlugnGo, Outdoor PlugnGo				
Fixture Mounting	Fixed Mounting Clip, Articulating Mounting Clip				
Environmental Rating	Dry				
Certifications	UL				
Warranty _{Limited}	5 years				
Product Dimensions _{SWxH}	1.25 x 0.50 in				
Operating Temp Range	-20 to 120 °F				
Storage Temp Range	-40 to 160 °F				
Weight	0.60 lb / ft				

Specifications subject to change without prior notification

Ordering Information

Example: LO-23H-827-115C-LE-IRB-FM

Product	Length ¹	Output	CRI ²	Color	Beam Angle	Lens	Ingress Cable Orientation	iPosition	Termination ³	Egress Cable Orientation ⁴	ePosition	Mount
LO	##	SO	80+	27	115	Clear	Left	End	IPG	Right	X - None	FM - Fixed Mount
			90+	30		Frosted	Right	Back	OPG	Left	End	AM - Articulating Mount
				35				Nearside			Back	
				40				Farside			Nearside	
				50							Farside	
				RED								
				GRN								
				BLU								
				AMB								

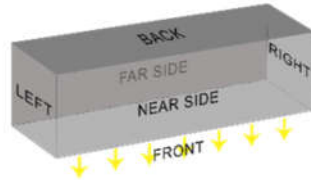

¹ Fixture length in inches, ² CRI does not apply to Colors; leave blank ³ Indoor PlugGo, Outdoor PlugGo or Flying leads ⁴ Will always be the opposite letter of the Ingress Cable Orientation (R or L)

Mounting Clips

Mounting Clips

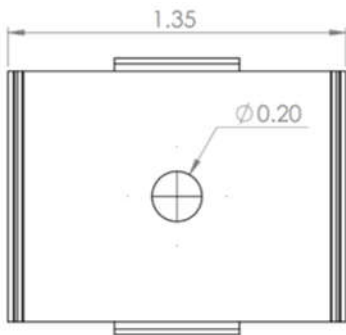

Fixed Mounting Clip

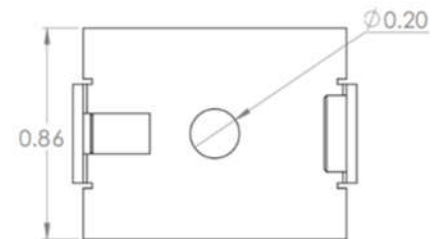
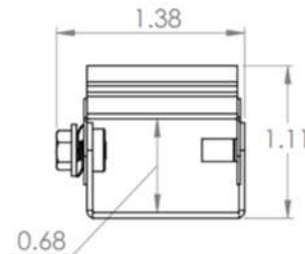
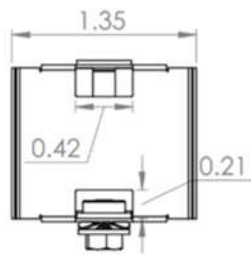
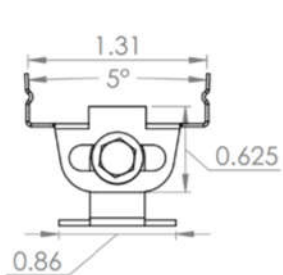
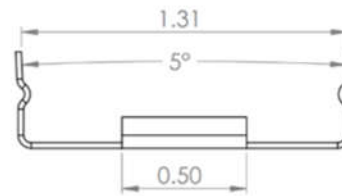
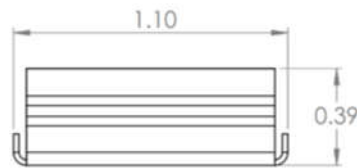

Articulating Mounting Clip

- All dimensions in INCHES

Dimming

The Luma Series of products are designed with a built-in dimming circuit that requires a 0 - 10 V_{DC} sinking dimming controller to properly function. Either a third party sinking dimmer controller can be used or select one of two available options in the LEDynamics LVD Series of dimmer solutions.

