



**Energy Efficient, High Quality,
LED Lighting Products**



SERIES XML/C
MINIATURE LUMINAIRES
with CREE® XLamp® XP-E LEDs

Prolume Series XML/C is a family of decorative miniature lighting fixtures designed around the CREE XLamp XP-E hi-flux LEDs. They are ideal for applications including accent lighting, display and showcase lighting, furniture lighting and more. Key features include...

- **Aesthetically Pleasing**
Recessed, low profile appearance in a variety of standard and custom finishes.
- **Machined Aluminum Housing**
Provides durability, cosmetics and thermal management.
- **CREE XLamp XP-E LEDs**
White light available in 5000°K, 4000°K and 3000°K CCT. Colors in blue, green, red and amber. Other options available. Consult factory.
- **50,000 Hour Operating Life**
As much as 20 years of useful light in most normal applications.
- **Light Distribution**
Available with or without optics to provide patterns from 10° narrow to 110° wide, as well as oval.
- **Installation**
Easily installs in walls, ceilings, millwork, etc., using provided VHB gasket or spring clips.
- **Electrical**
Rated for class II wiring methods, power can be supplied from a full range of available drivers including dimming drivers.



Fixture Schedule

Type Model Number

Job:

Remarks:



HIGHLY INNOVATIVE • TECHNOLOGY BASED • QUALITY LIGHTING PRODUCTS

525 Fan Hill Road • Monroe • Connecticut 06468
Phone (800) EXIT-LED • FAX (203)268-7855
www.prolumeLED.com
email: info@prolumeled.com

SERIES XML/C PRODUCT SPECIFICATIONS / ORDERING GUIDE

HOUSINGS / FINISHES

Standard fixture housings are machined from aluminum bar stock and offered in a variety of standard finishes. Custom metals and finishes are also available. Consult factory. Provided with spring clips and VHB tape for universal installation. Indoor use only.

CREE® XLamp® XP-E LEDs

Fixtures utilize CREE XLamp XP-E LEDs in a full range of color temperatures and colors. With proven lighting-class performance and reliability, they retain 70% of their initial light output after 50,000 hours of operation.

THERMAL MANAGEMENT

Housing mass and surface area design, and the use of heat sinking materials in the basic system design bring LED junction temperatures to ambient, allowing the fixture to run cool to the touch.

LIGHT DISTRIBUTION

Provided both as a function of the individual LED viewing angle and a choice of four (4) different lensing options. Consult factory for photometric data files.

ELECTRICAL / POWER

A full range of LED drivers, including dimming drivers, are available to supply power to individual fixtures or an array of connected fixtures using class II wiring methods. See separate catalog sheets or consult factory. **Power Rating: 1.1W / fixture**

DIMMING

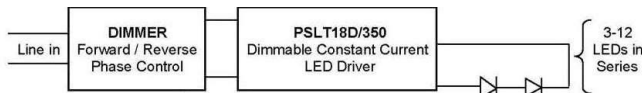

Consult Factory for other driver options

DIMENSIONS

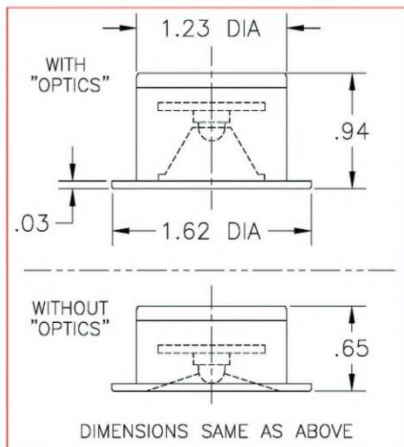

LENS SELECTOR		
Description	Full Width Viewing Angle	Ordering Suffix
OVAL	8° x 47°	- O
SPOT	10.4°	- S
MEDIUM	17.9°	- M
WIDE	31.5°	- W
NO LENS	WHITE LEDs / 110°	- N
	COLOR LEDs / 130°	- N

LED SELECTOR			
Color*	CRI	Lumens** @ 350mA	Ordering Suffix
5000K White	75 typ	100	C750
4000K White	75 typ	95	N740
3000K White	80 typ	90	W830
Red 620-630nm	N/A	55	R
Amber 585-595nm	N/A	60	A
Green 520-535nm	N/A	90	G
Blue 465-485nm	N/A	30	B

*Consult factory for other color options

**Typical Luminous Flux at LED junction temp of 25°C

ORDERING INFORMATION

Specify...

SERIES – LED COLOR – LENS – FINISH

XML/C	C750 N740 W830 RED AMBER GREEN BLUE	OVAL SPOT MEDIUM WIDE NONE	WHITE BLACK NATURAL CHROME SPECIAL

EXAMPLE

MODEL XML/C-C750-M-W

Fixture with CREE (5000°K) LED, medium lens in white finish.